

Ø	D	R	H	Sp
1/2"	12.7	26	26	1.6
3/4"	19.05	29	34	1.6
1"	25.4	38	40	1.6
1"1/2	38.1	56	56	1.6
2"	50.8	75	75	1.6
2"1/2	63.5	84	85	1.6
3"	76.2	85	85	2
4"	101.6	110	110	2

DN	D	R	H	Sp
10	12	26	26	1.5
15	18	35	35	1.5
20	22	40	40	1.5
25	28	50	50	1.5
32	34	52	55	1.5
40	40	60	60	1.5
50	52	72	72	1.5
60	60	75	75	1.5
65	70	85	85	2
80	85	93	95	2
100	104	110	110	2

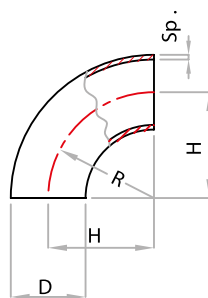

COD. CS90D..x..G/L/LL-6

Curva a 90° con
estremità a saldare
90° Elbow Weld Ends
MAT. AISI 316L



Ø	D	R	H	Sp
1/2"	12.7	26	40	1.6
3/4"	19.05	29	50	1.6
1"	25.4	38	75	1.6
1"1/2	38.1	56	90	1.6
2"	50.8	75	100	1.6
2"1/2	63.5	84	115	1.6
3"	76.2	85	130	2
4"	101.6	110	150	2

DN	D	R	H	Sp
10	12	38	26	1.5
15	18	47	35	1.5
20	22	52	40	1.5
25	28	70	50	1.5
32	34	78	55	1.5
40	40	90	60	1.5
50	52	100	72	1.5
60	60	110	75	1.5
65	70	110	85	2
80	85	130	95	2
100	104	150	110	2

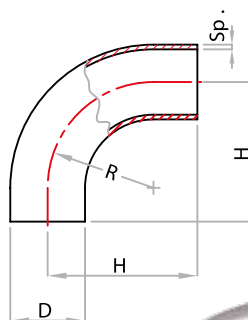

COD. CM90D..x..G/L/LL-6

Curva a 90° con
estremità a mandrinare
*90° Elbow Expanding
Welds Ends*
MAT. AISI 316L



Curva Clamp serie B.S.
B.S. Elbow Clamp



Curva Clamp serie B.S.
B.S. Elbow Clamp

COD. 2KMP45ELL-...-LL-6

Curva a 45°
45° Elbow Clamps Ends
MAT. AISI 316L

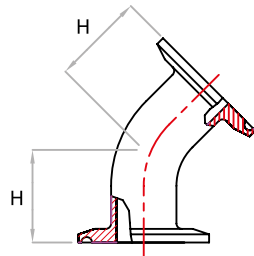

Misura / Size	1/2"	3/4"	1"	1"1/2	2"	2"1/2	3"	4"
H	70	70	28.6	36.5	44.5	52.4	60.3	79.4



COD. 2CMP90ELL-...-LL-6

Curva 90°
90° Elbow Clamp Ends
MAT. AISI 316L

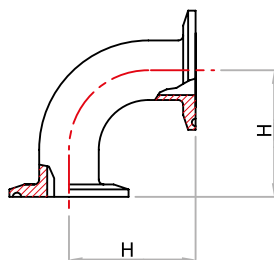

Misura / Size	1/2"	3/4"	1"	1"1/2	2"	2"1/2	3"	4"
H	38.5	46.5	52.5	68.5	87.5	97.5	97.5	122.5

